



APARTMENT 1, 4 LOW PAVEMENT NOTTINGHAM

£975 Per

Fully furnished 1 bedroom apartment located in a converted luxury development of just 4 apartments in the heart of the City Centre, on the door step to all the City offices, shops, restaurants and transport services.

The apartment comprises of:

- Located on the first floor towards the rear of the building.
- Open plan living kitchen complete with sofa and coffee tables and fold out dining table.



- SEE VIRTUAL VIDEO TOUR LINK • Converted in 2025 • Fully furnished with high quality presentation • Great location! Walking distance to all city centre amenities



- Double glazed windows
- Combination of LVT flooring and carpet
- Integrated kitchen appliances
- Open plan living / kitchen
- Excellent Transport Links



Apartments 1 - 4 4 Low Pavement NG1 7DL

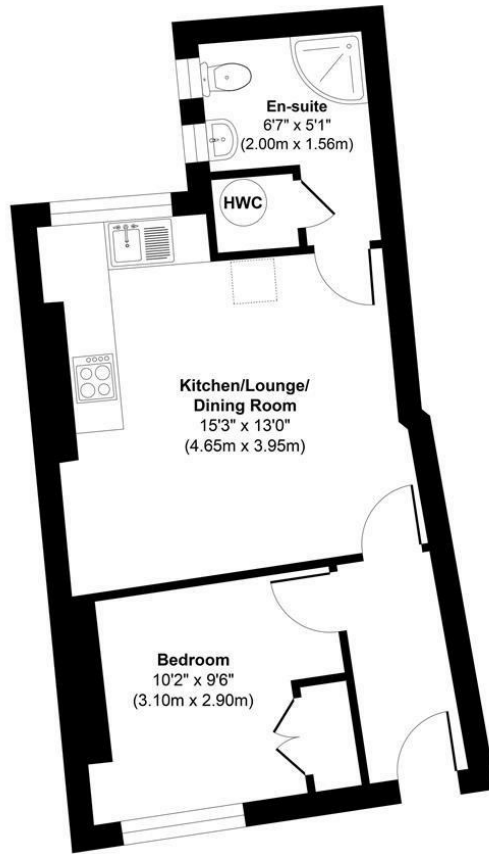

First Floor Flat 1

Approx. Gross Internal Floor Area 400 sq. ft / 37.13 sq. m
 Illustration for identification purposes only, measurements are approximate, not to scale.
 Produced by Elements Property



Energy Efficiency Rating		
	Current	Potential
<i>Very energy efficient - lower running costs</i>		
(92 plus) A		
(81-91) B		
(69-80) C		
(55-68) D		
(39-54) E	53	53
(21-38) F		
(1-20) G		
<i>Not energy efficient - higher running costs</i>		
England & Wales	EU Directive 2002/91/EC	

EPC Rating: E Council Tax Band: A

Agents Note: Whilst every care has been taken to prepare these particulars, they are for guidance purposes only. All measurements are approximate and are for general guidance purposes only and whilst every care has been taken to ensure their accuracy, they should not be relied upon and potential buyers/tenants are advised to recheck the measurements

Nottinghamshire
 1 East Circus Street
 Nottingham
 NG1 5AF

01157043163
 enquiries@kingswoodrim.co.uk
 www.kingswoodrim.co.uk

